

1/1 蓄电池

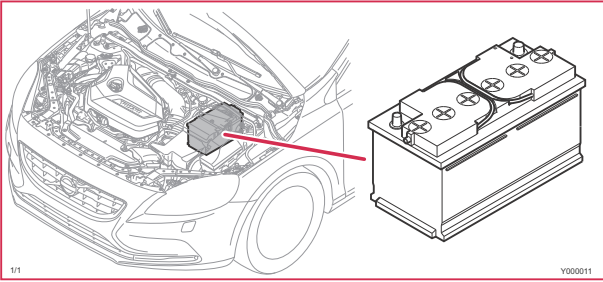

2/17 喇叭继电器

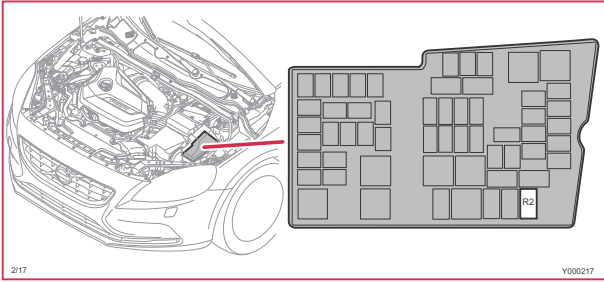

1/3 二级蓄电池

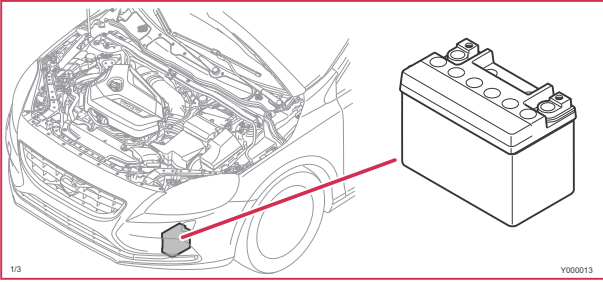

2/22 恒温控制系统继电器

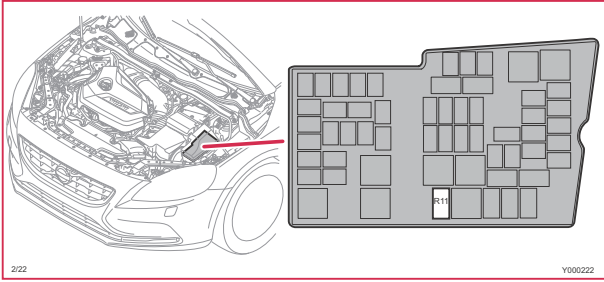

2/11 冷却风扇继电器

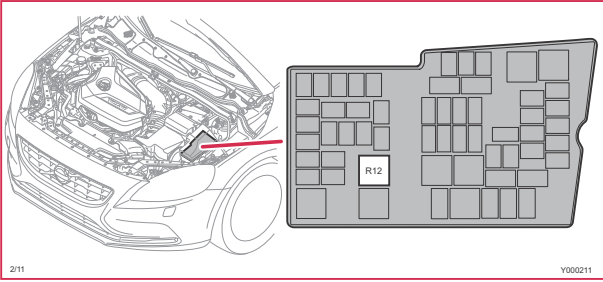

2/31 继电器，15 馈路

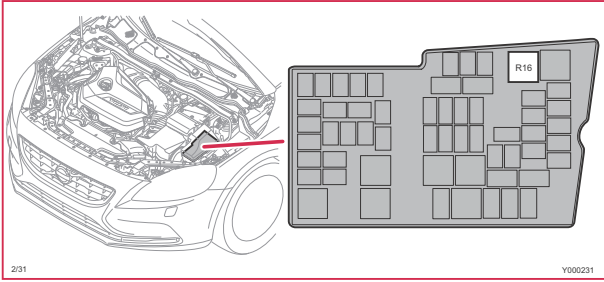

2/14 预热塞系统继电器

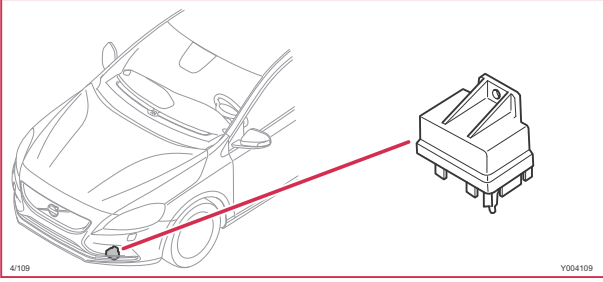

2/32 发动机管理系统主继电器

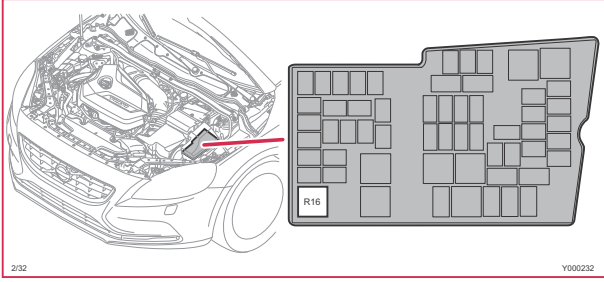

2/16 后窗雨刷继电器

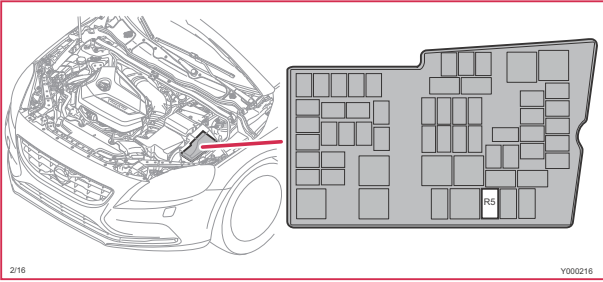

2/35 起动机马达继电器

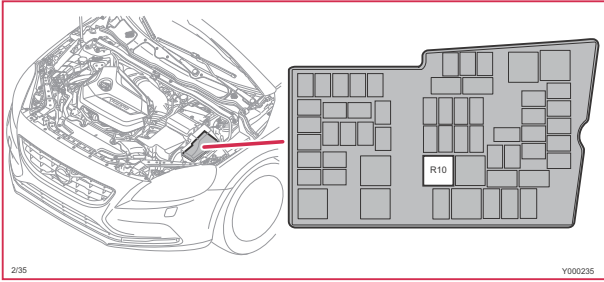

2/52 15 馈路继电器，后

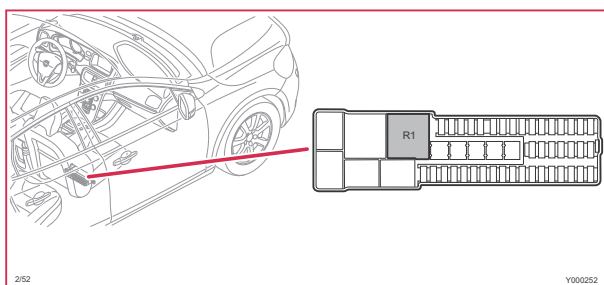

2/107 乘客车厢风扇继电器

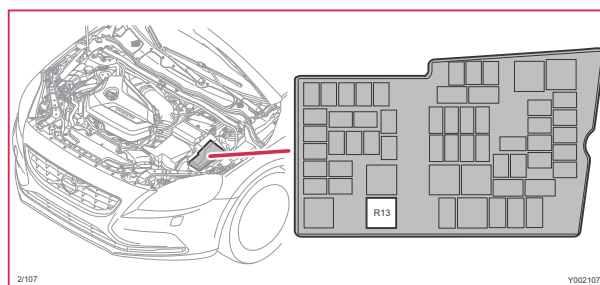

2/81 电子加热式车窗继电器

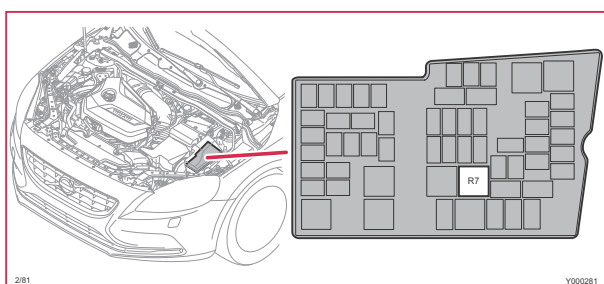

2/142 燃油过滤器预热器继电器

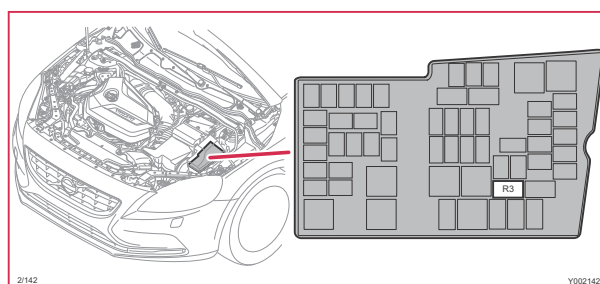

2/82 电热后车窗继电器

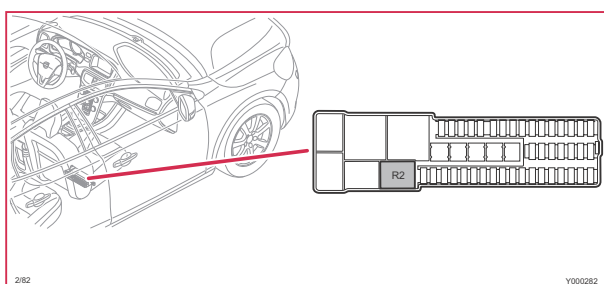

2/182 头灯喷洗器马达继电器

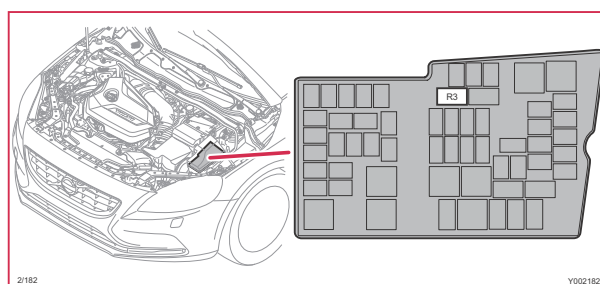

2/92 挡风玻璃喷洗器马达继电器

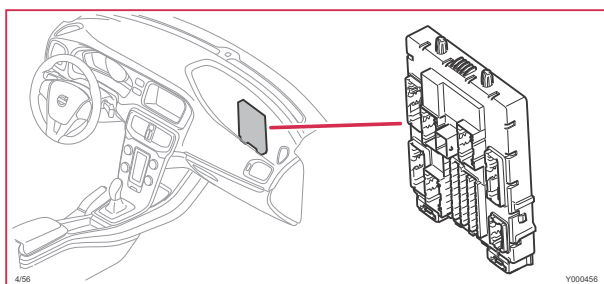

2/193 舒适功能继电器

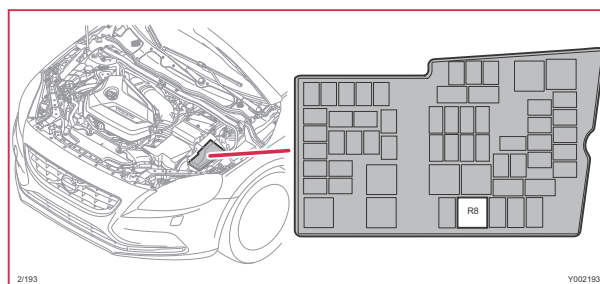

2/93 后车窗喷洗器马达继电器

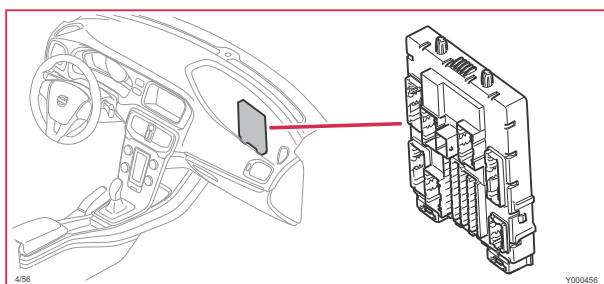

2/239 冷却液泵继电器

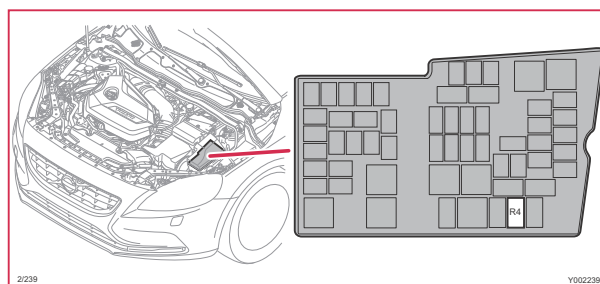

2/242 蓄电池断路器继电器

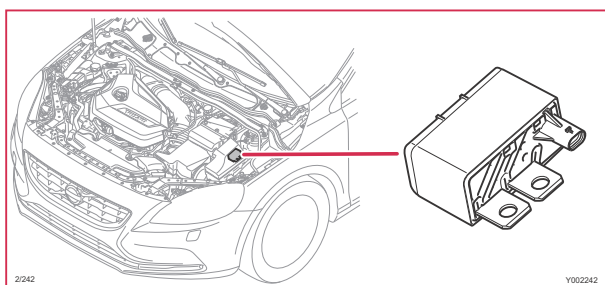

3/9 触点式制动灯

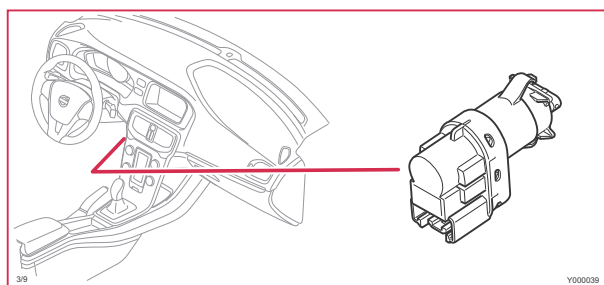

3/1 起动控制

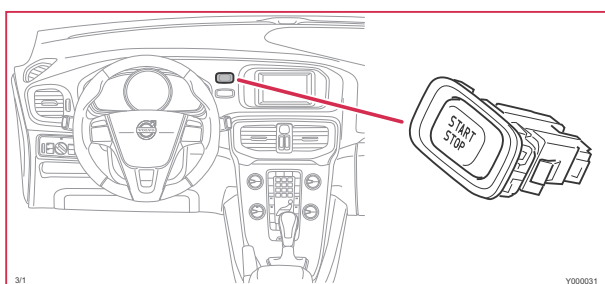

3/10 倒车灯接头

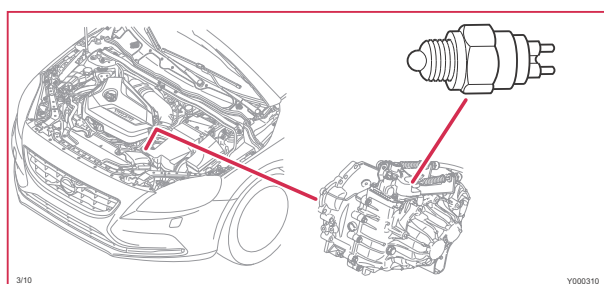

3/4 方向盘左侧开关 (SWSL)

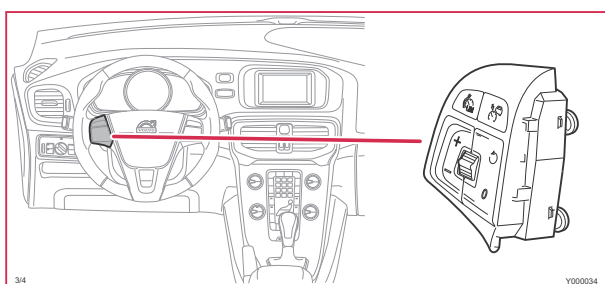

3/15 中央控制单元驾驶人车门电动窗开关

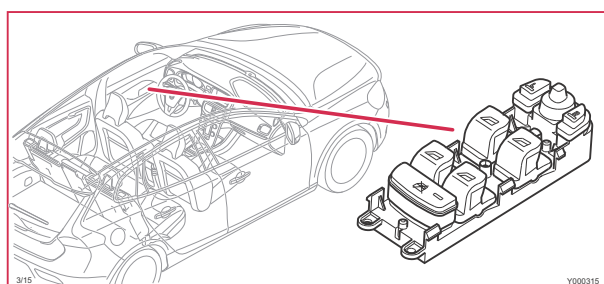

3/6 危险警告闪烁灯开关

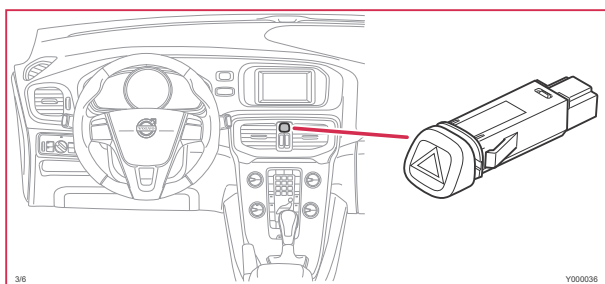

3/19 左后车门电动窗开关

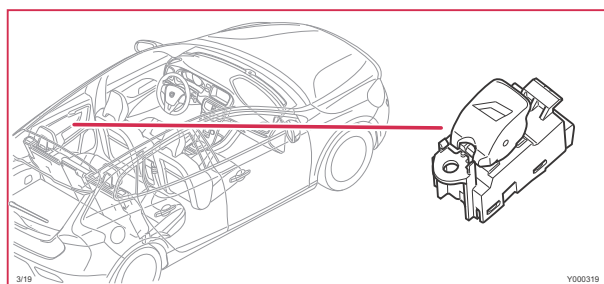

3/8 电热后车窗 / 后视镜开关

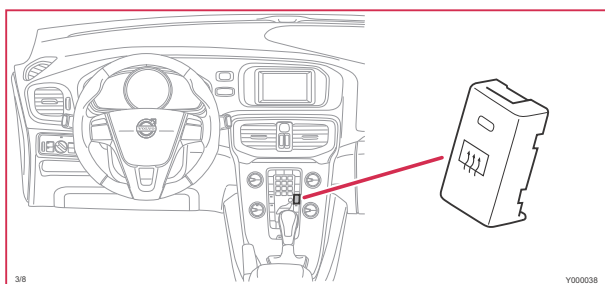

3/20 乘客车门电动车窗开关

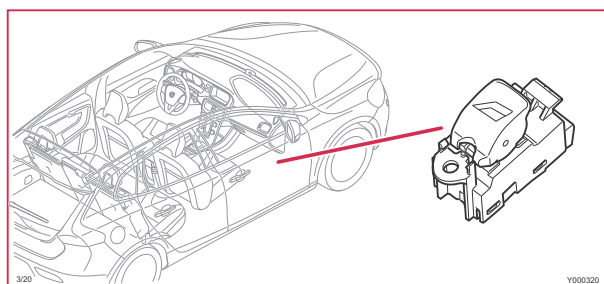

3/20.2 乘客车门电动车窗开关

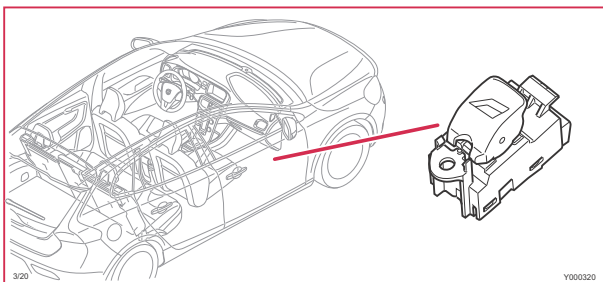

3/35 行李箱盖 / 尾门开关把手

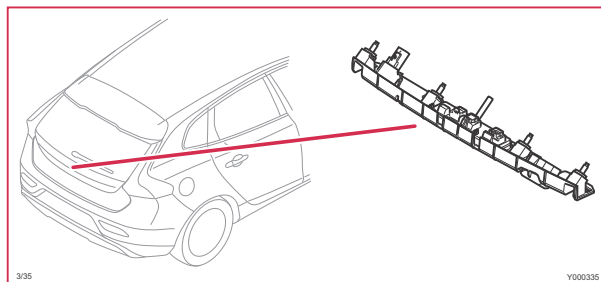

3/21 右后车门电动窗开关

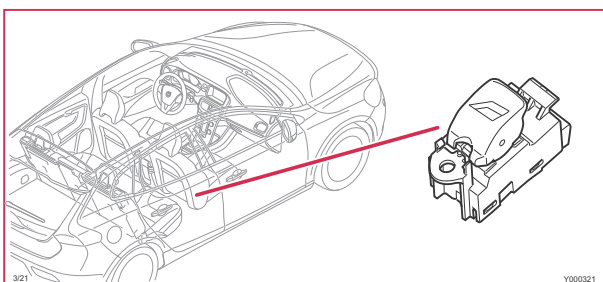

3/37 触点式喇叭

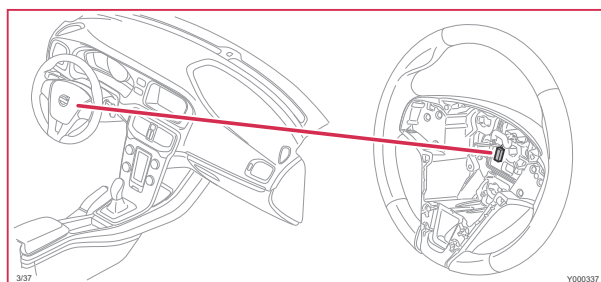

3/25 电动天窗开关

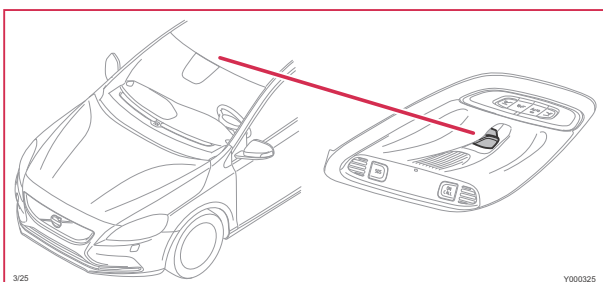

3/38 刹车开关

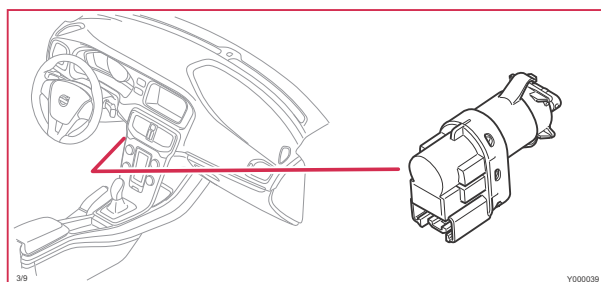

3/26 电动驾驶员座椅开关单元

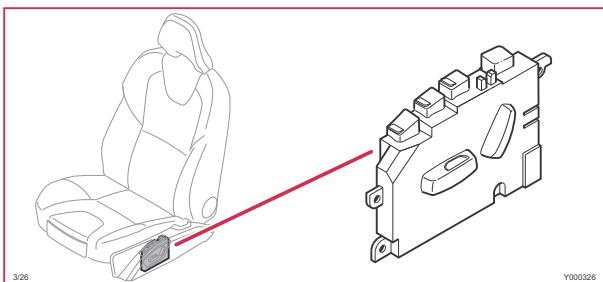

3/47 驻车制动触点

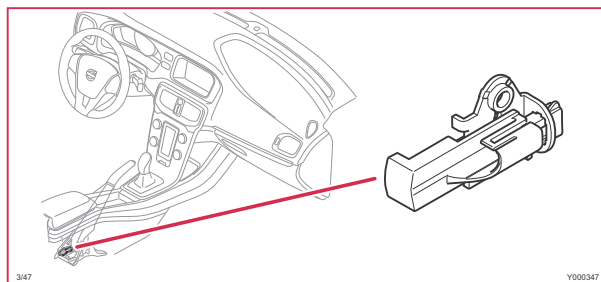

3/27 电动乘客座椅开关单元

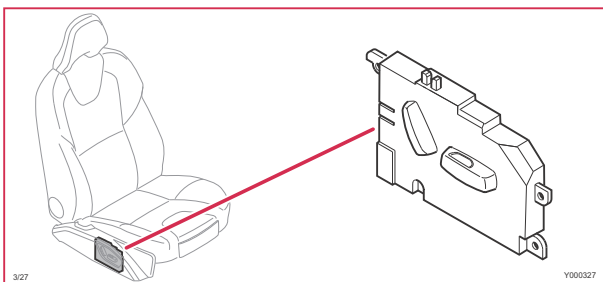

3/62 发动机盖警报器开关

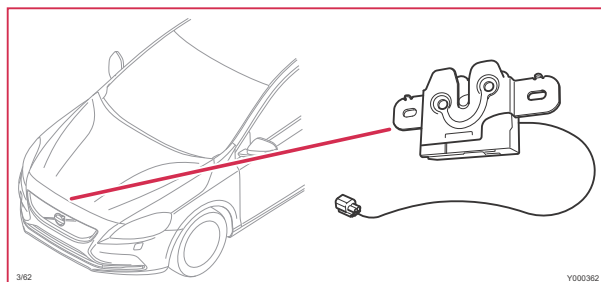

3/65 开关，加热式后座椅

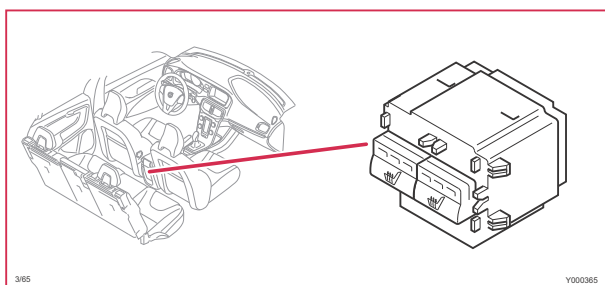

3/85 左后车门电动窗开关

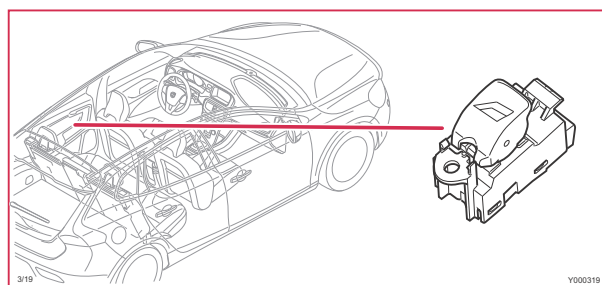

3/80 驾驶员车门中央锁系统开关

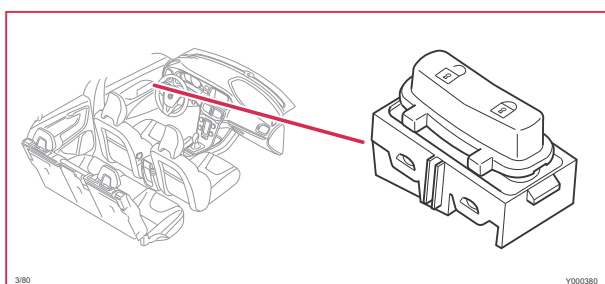

3/86 右后车门电动窗开关

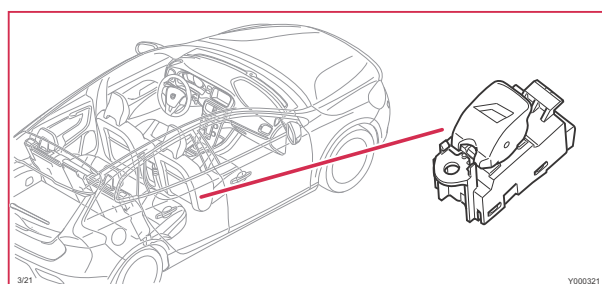

3/80.1 驾驶员车门中央锁系统开关

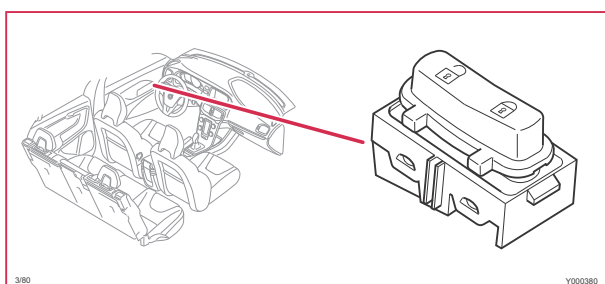

3/93 驾驶员座椅安全带扣锁开关

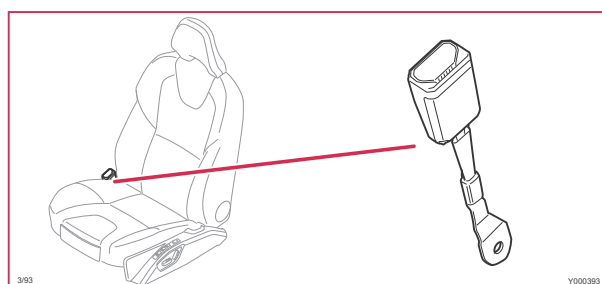

3/80.2 驾驶员车门中央锁系统开关

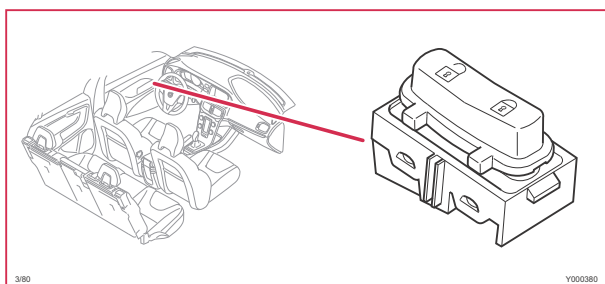

3/94 乘客座椅安全带扣锁开关

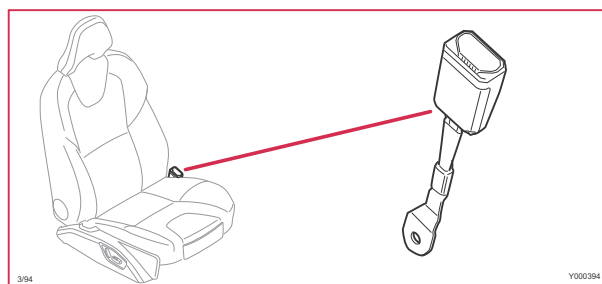

3/83 乘客车门电动车窗开关

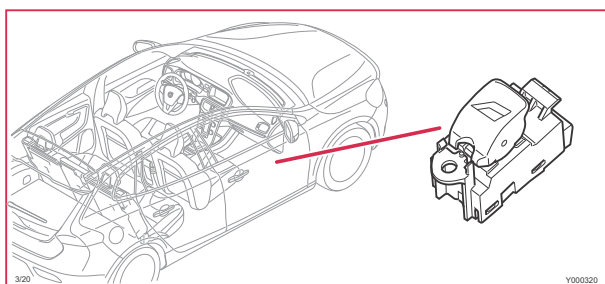

3/111 灯开关模块 (LSM)

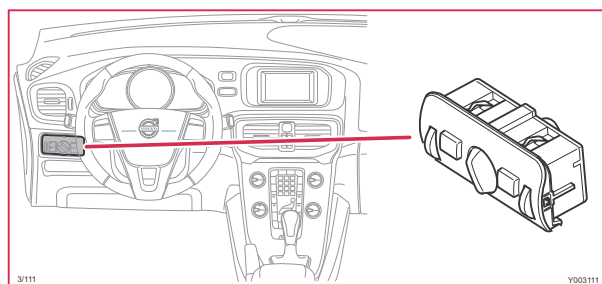

3/112 恒温控制系统

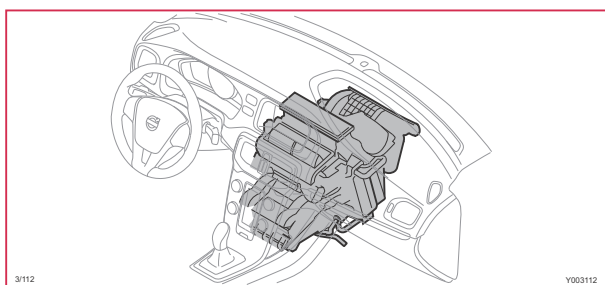

3/128 左后车门模块 (LDM)

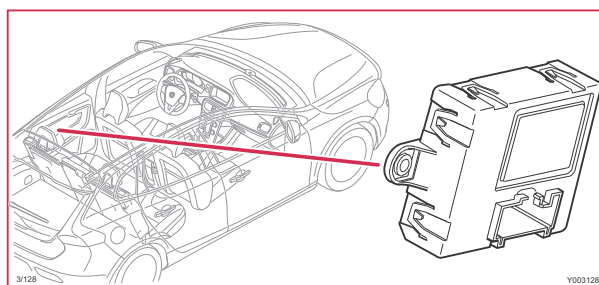

3/117 车顶灯开关单元

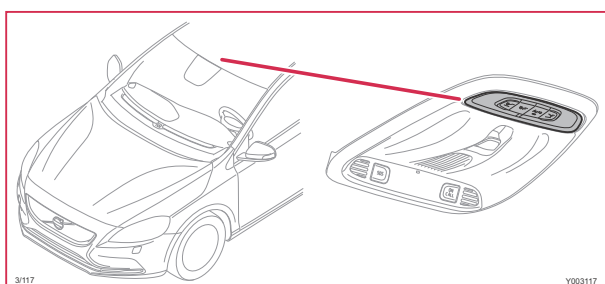

3/129 右后车门模块 (RDM)

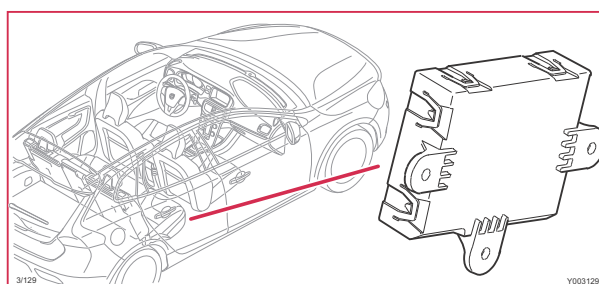

3/120 发动机盖警报器开关

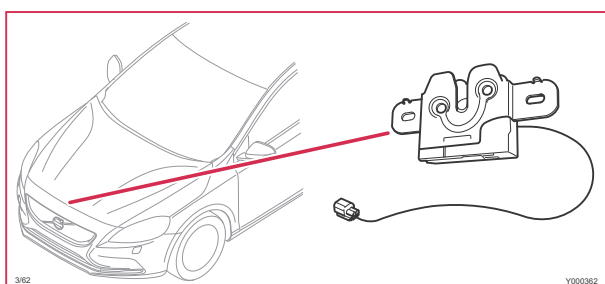

3/130 方向盘模块 (SWM)

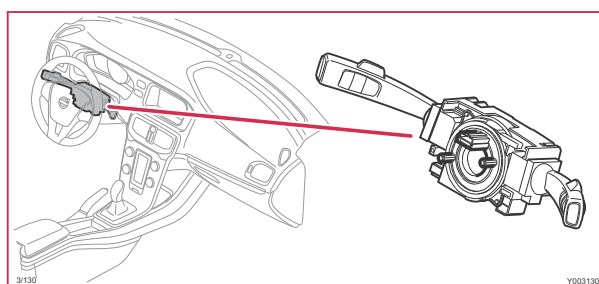

3/126 驾驶员车门模块 (DDM)

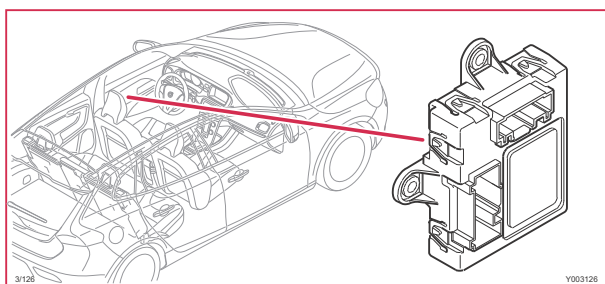

3/131 方向盘右侧开关 (SWSR)

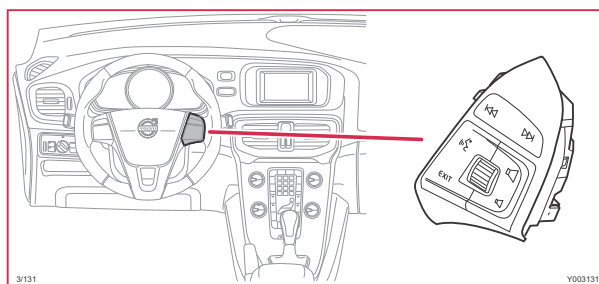

3/127 乘客车门模块 (PDM)

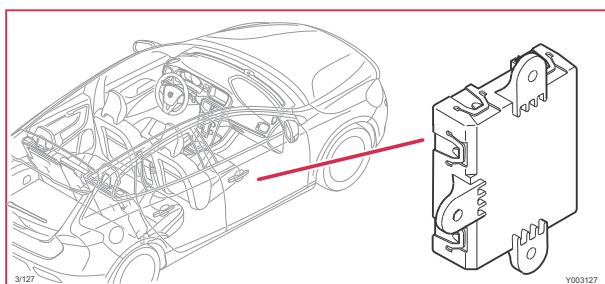

3/132 起动控制模块 (SCU)

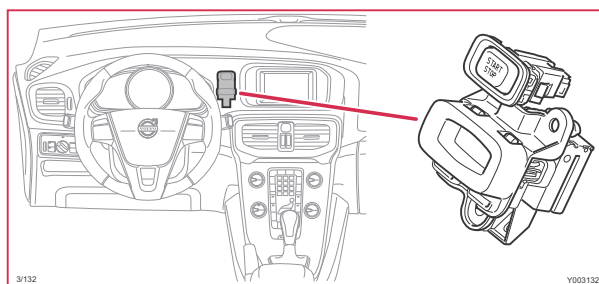

3/135 RTI 开关

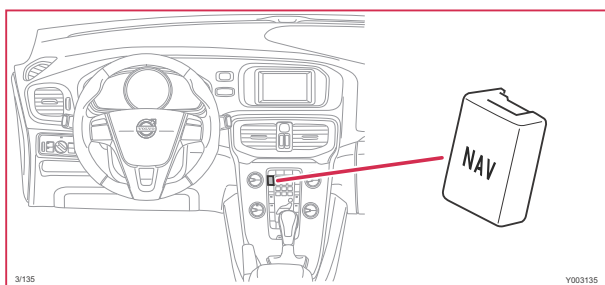

3/217 后座左安全带扣锁开关

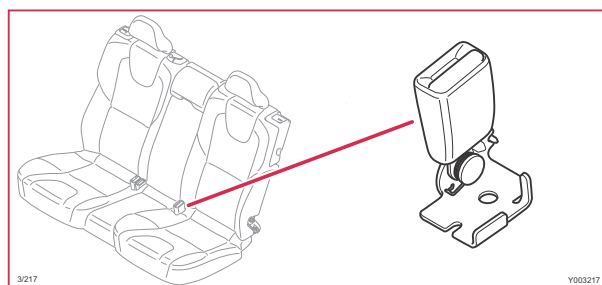

3/156 换档杆模块 (GSM)

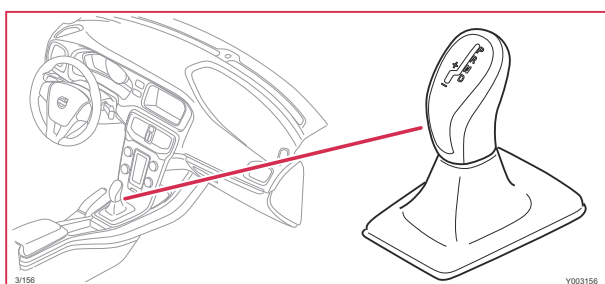

3/218 后座中安全带扣锁开关

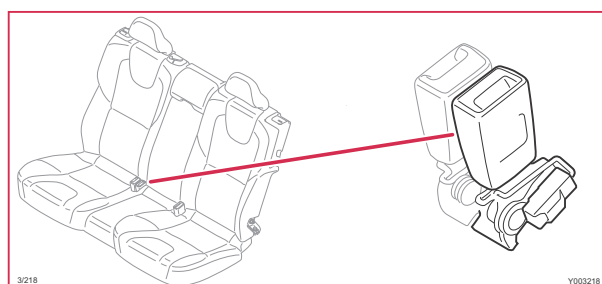

3/157 乘客侧安全气囊开关

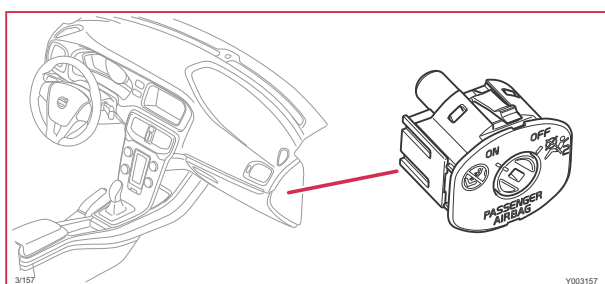

3/219 后座右安全带扣锁开关

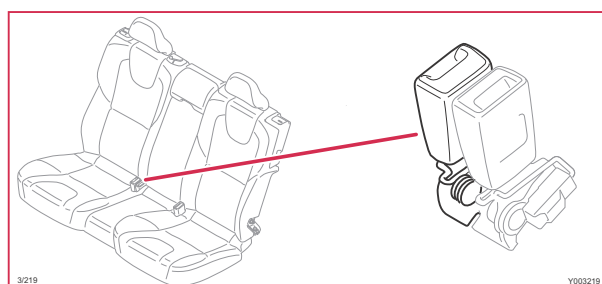

3/161 左侧化妆镜照明系统

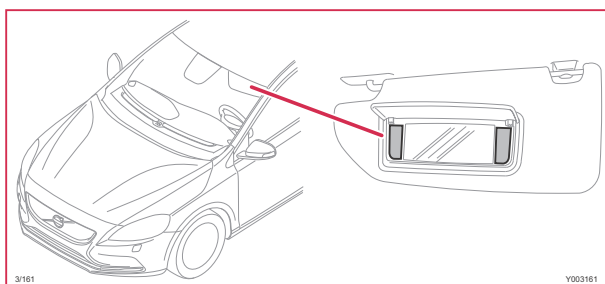

3/267 远程通讯开关单元

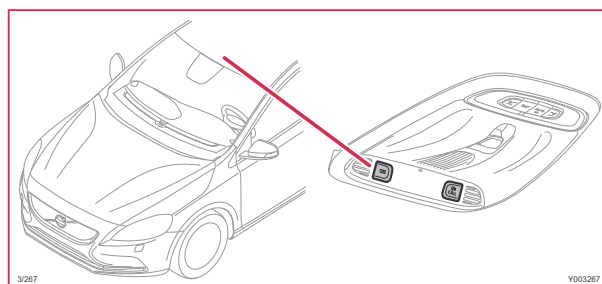

3/176 电动车窗开关, 驾驶员车门

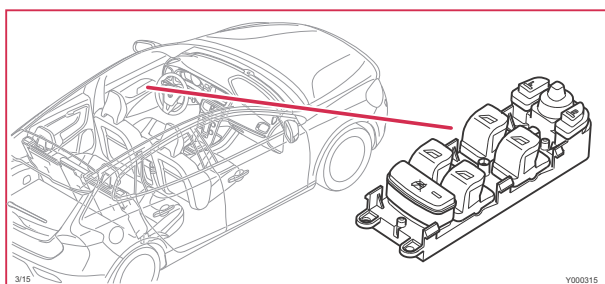

3/269 开关, 加热式后座椅

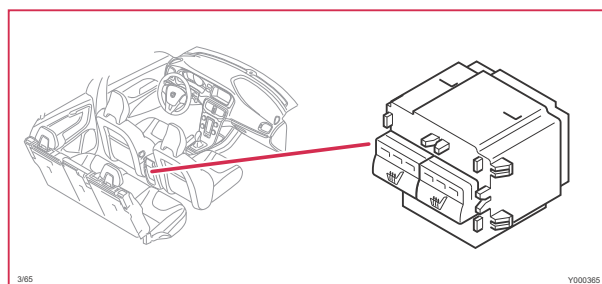

3/271 离合器踏板开关起动抑制器

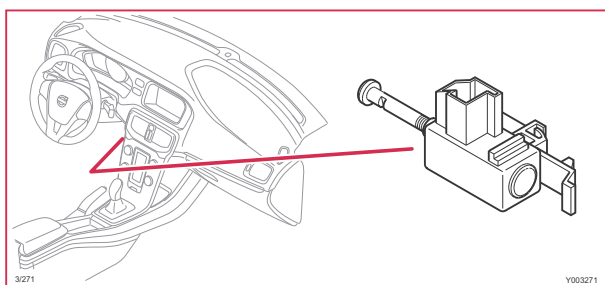

3/281 信息娱乐控制模块 (ICM)

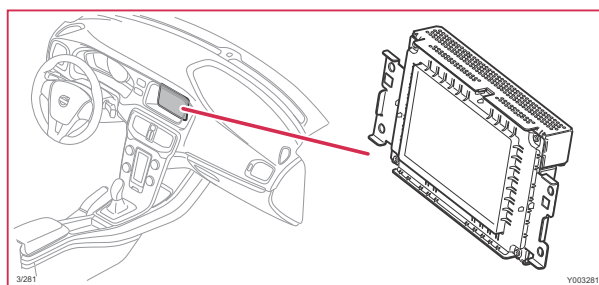

3/273 锁止触点, 左前车门

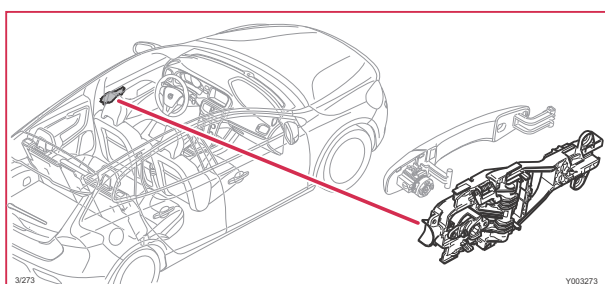

3/293 汽车电话免提控制面板

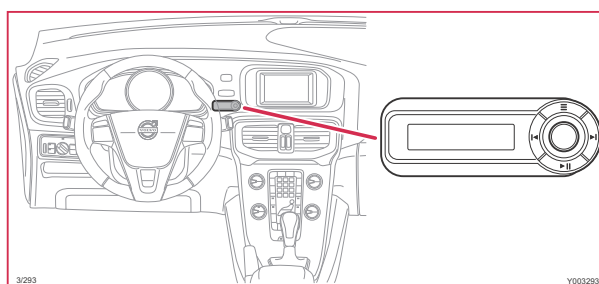

3/274 锁止触点, 右前车门

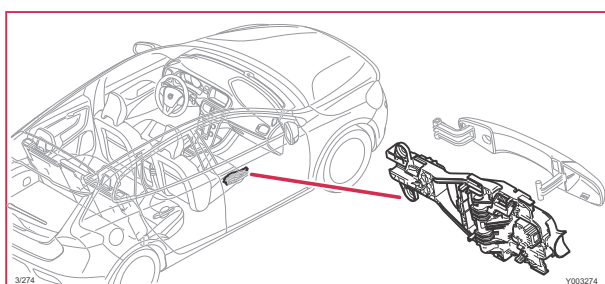

3/309 车顶控制台开关单元

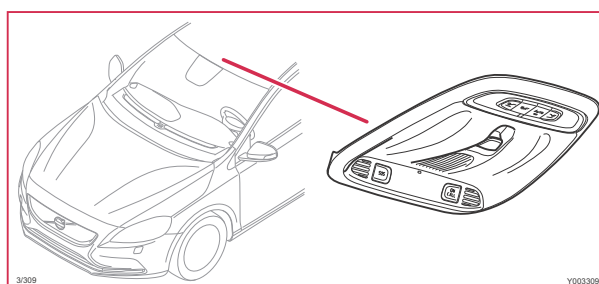

3/275 锁止触点, 左后车门

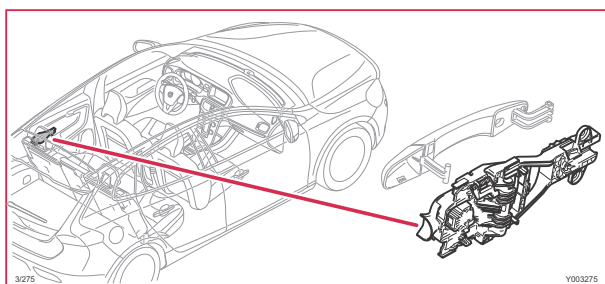

4/6 恒温控制模块 (CCM)

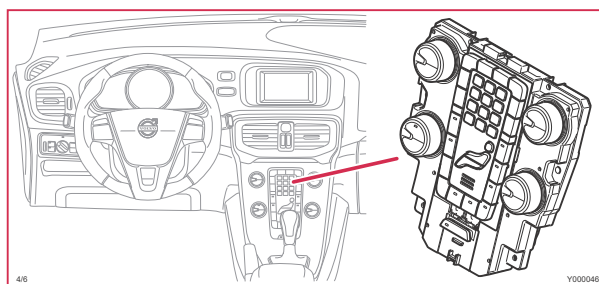

3/276 锁止触点, 右后车门

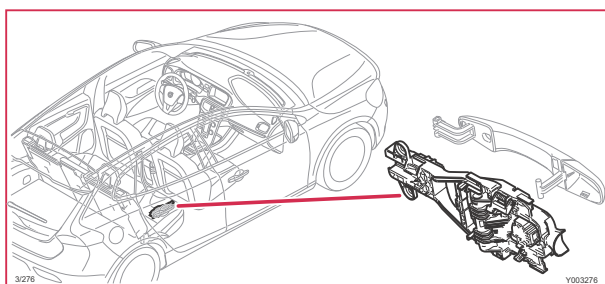

4/7 燃烧预热器模块 (CPM)

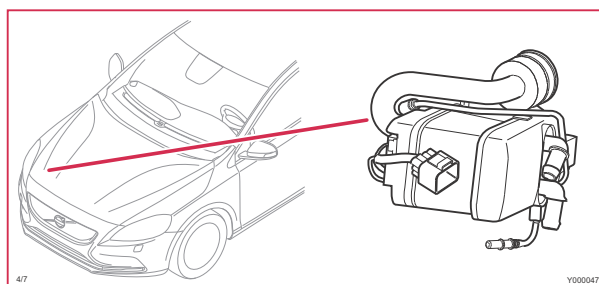

4/9 安全辅助系统模块 (SRS)

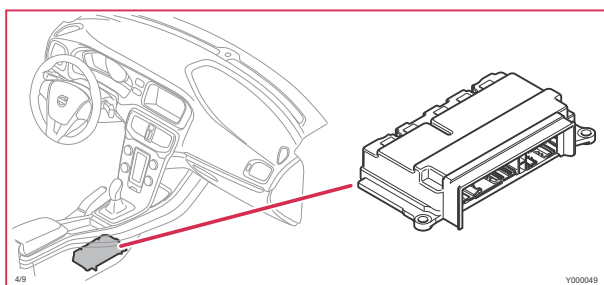

4/33 天窗控制模块

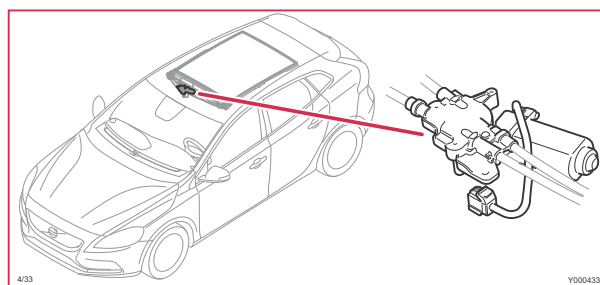

4/16 制动器控制模块 (BCM)

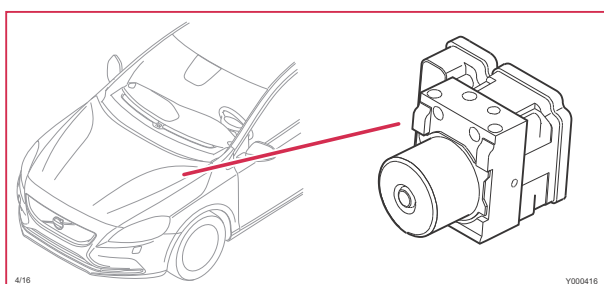

4/46 发动机控制模块 (ECM)

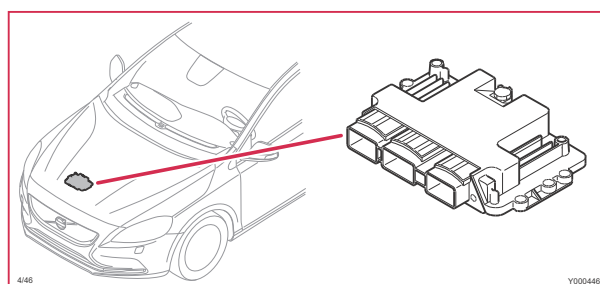

4/28 变速箱控制模块 (TCM), AWF21

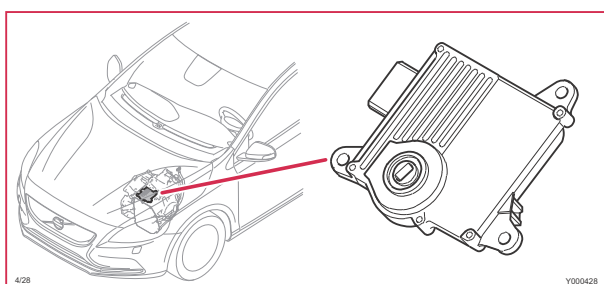

4/50 电子节流阀模块

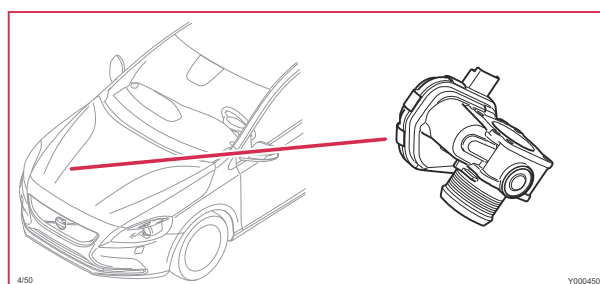

4/28 变速箱控制模块 (TCM), MPS6

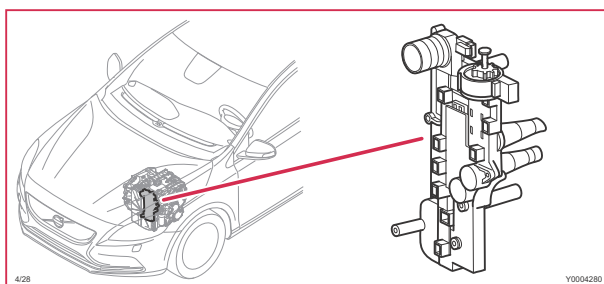

4/52 电动座椅模块 (PSM)

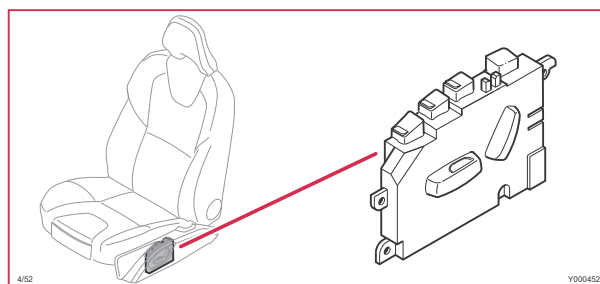

4/31 乘客车厢风扇控制模块

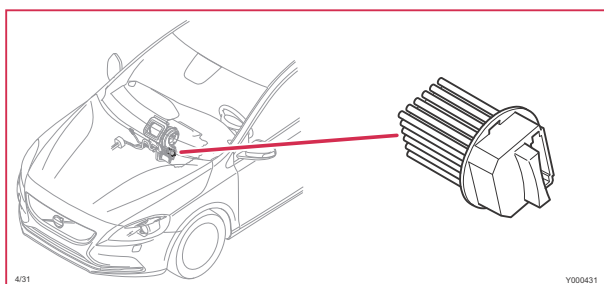

4/56 中央电子模块 (CEM)

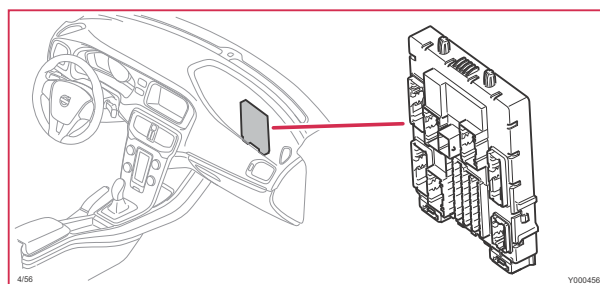

4/68 方向盘角度传感器模块 (SAS)

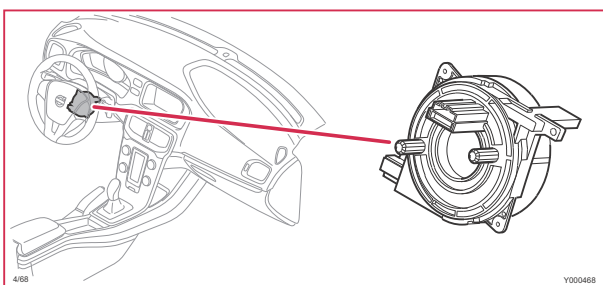

4/86 驻车辅助模块 (PAM)

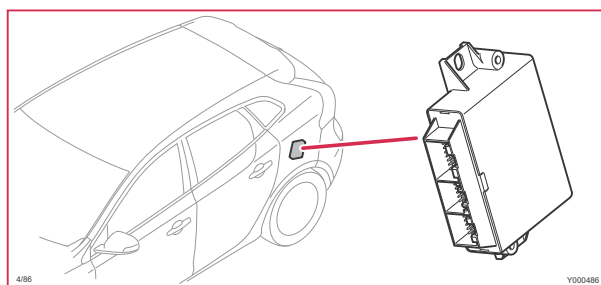

4/71 冷却风扇控制模块

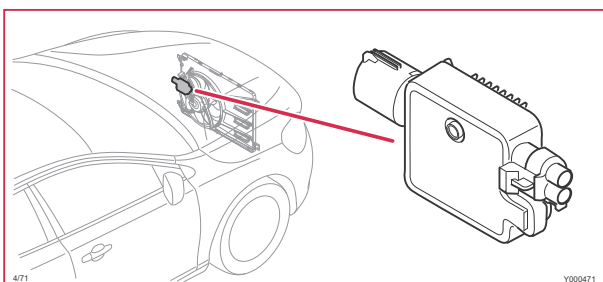

4/93 无钥匙车辆模块 (KVM)

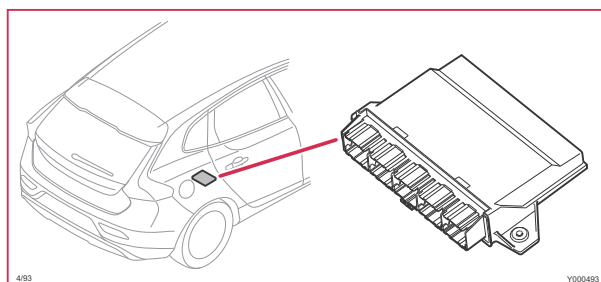

4/80 前方感应模块 (FSM)

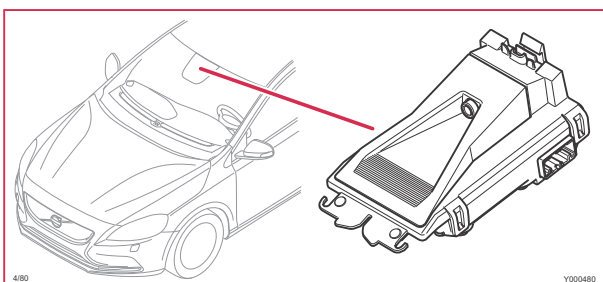

4/98 交流发电机控制模块 (ACM)

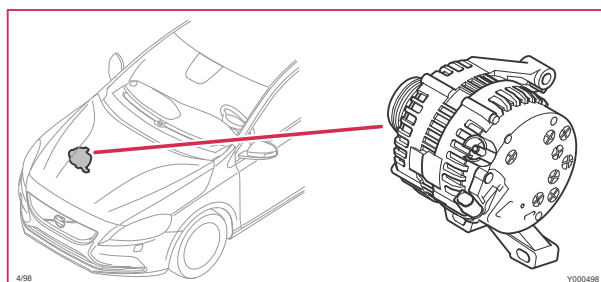

4/82 差动电子模块 (DEM)

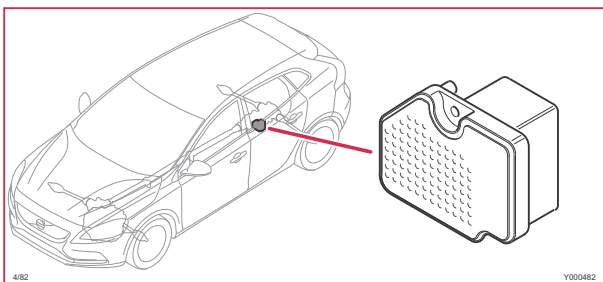

4/102 转向柱锁模块 (SCL)

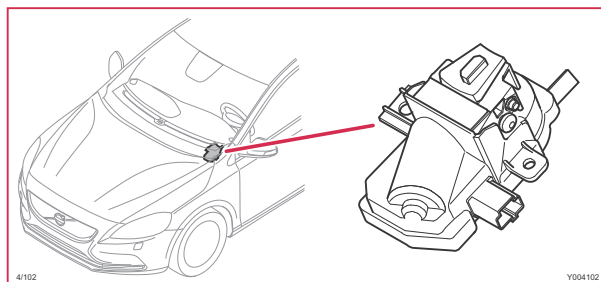

4/83 燃油泵控制模块

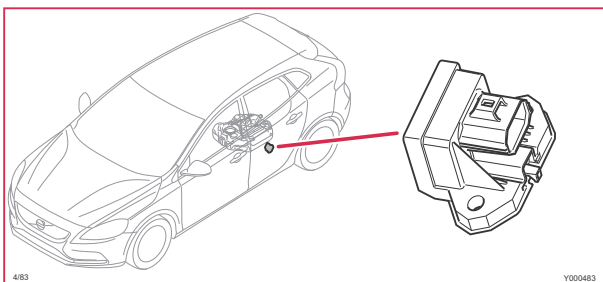

4/109 预热塞控制模块

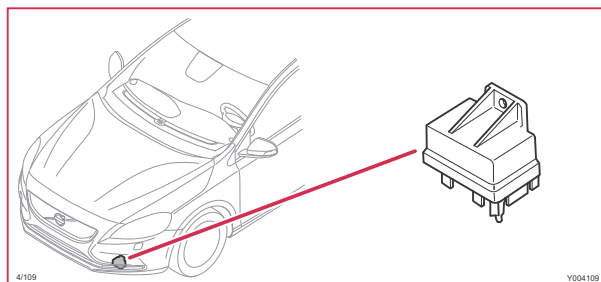

4/110 拖车模块 (TRM)

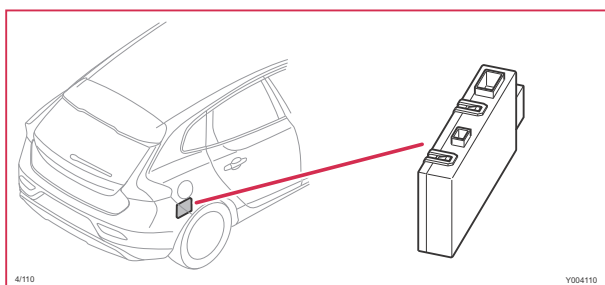

4/127 右侧障碍物侦测控制模块 (SODR)

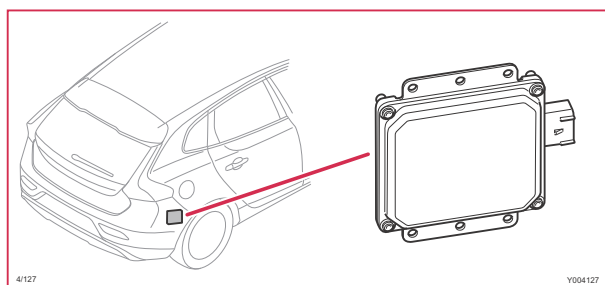

4/119 遥控无钥匙进入 (TRX)

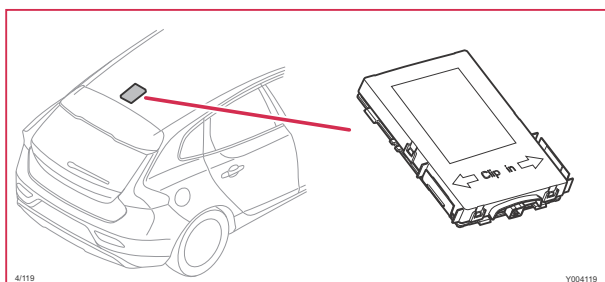

4/129 遥控无钥匙进入 (LRX)

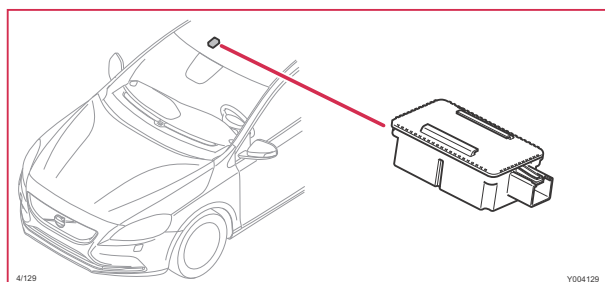

4/120 驻车辅助摄像机模块 (PAC)

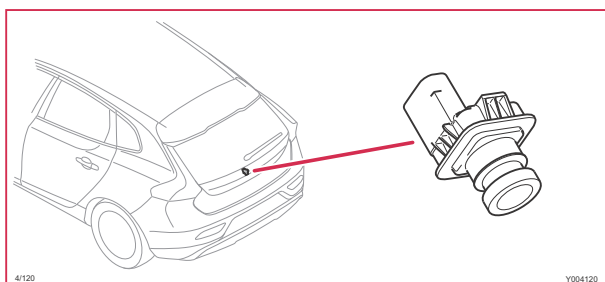

4/137 行人保护模块 (PPM)

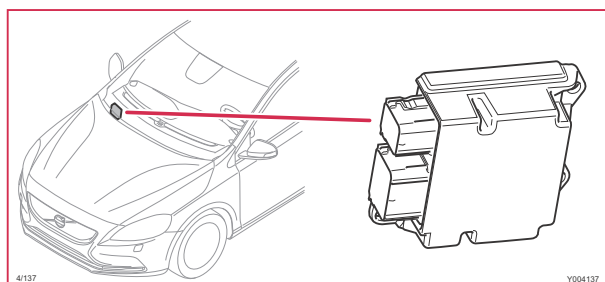

4/125 接近速度模块 (CVM)

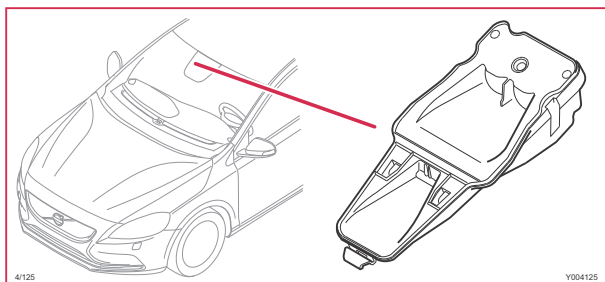

5/1 驾驶员信息模块 (DIM)

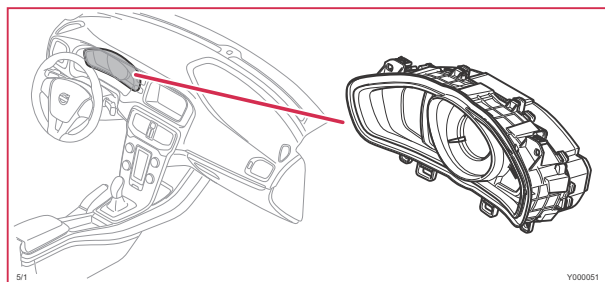

4/126 左侧障碍物侦测控制模块 (SODL)

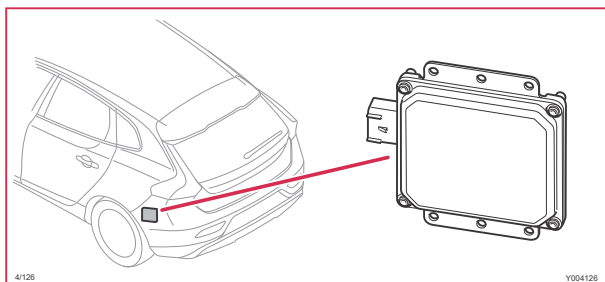

6/1 雨刮器马达模块 (WMM)

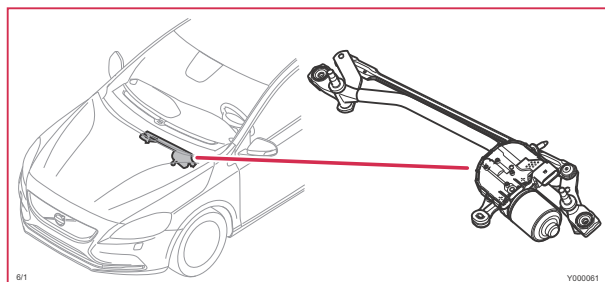

6/5 锁止马达，中央锁，右前车门

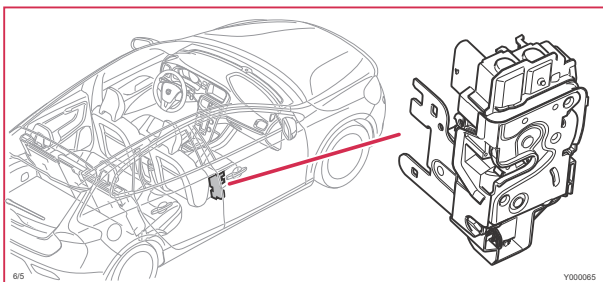

6/11 右前电动窗马达

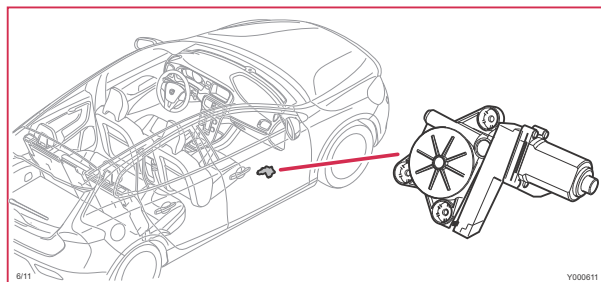

6/6 锁止马达，中央锁，右后车门

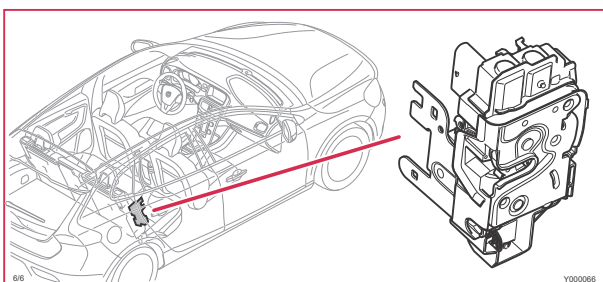

6/16 驾驶人座椅椅背角度调节马达

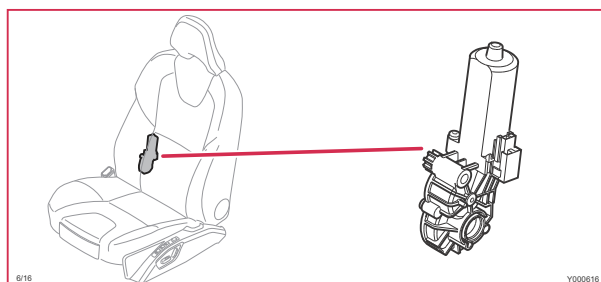

6/7 锁止马达，中央锁，右前车门

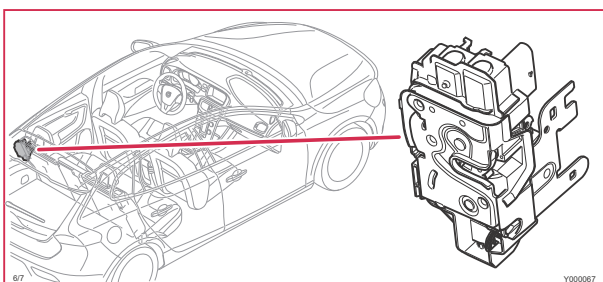

6/17 驾驶人座椅前缘高低调节马达

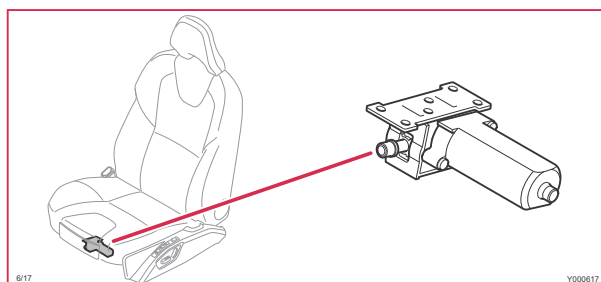

6/8 中央锁马达，行李箱盖

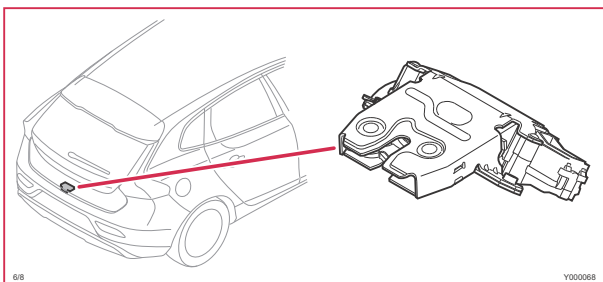

6/18 驾驶人座椅后缘高低调节马达

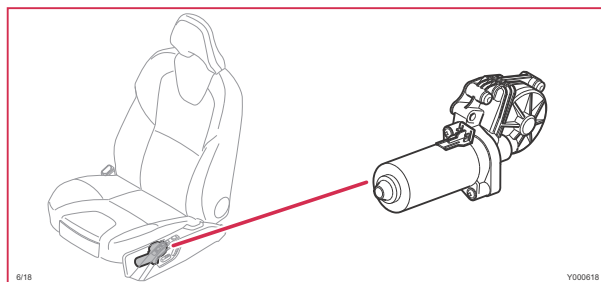

6/9 左前电动窗马达

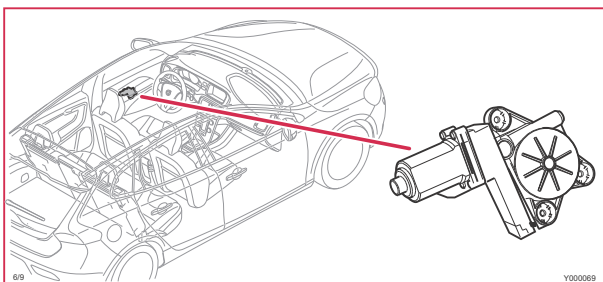

6/19 驾驶人座椅前后调节马达

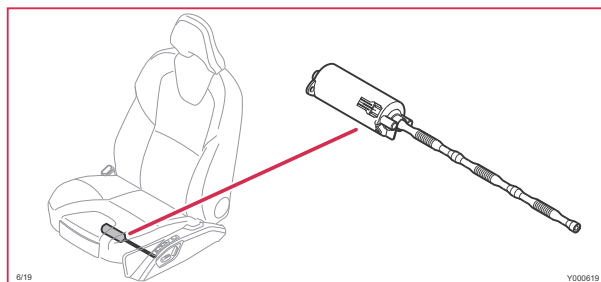

零件插图 6/20 - 6/35

6/20 乘客座椅马达，向前 / 向后

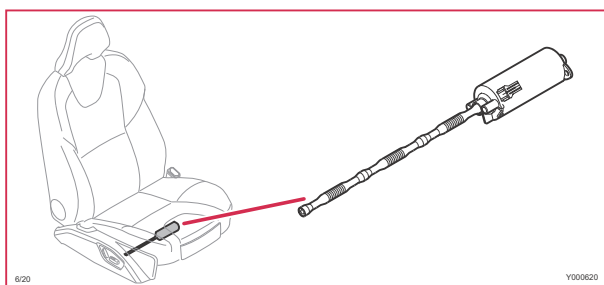

6/26 交流发电机控制模块 (ACM)

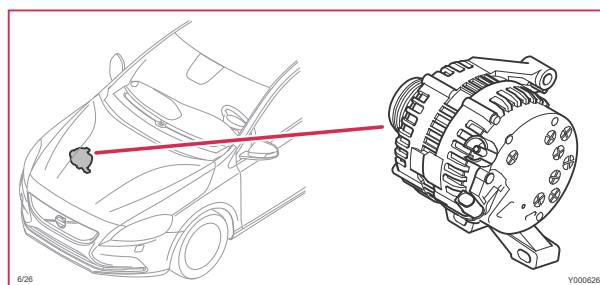

6/21 乘客座椅，向上 / 向下前缘

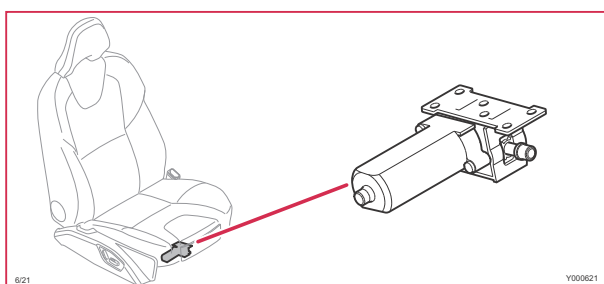

6/28 乘客车厢风扇马达

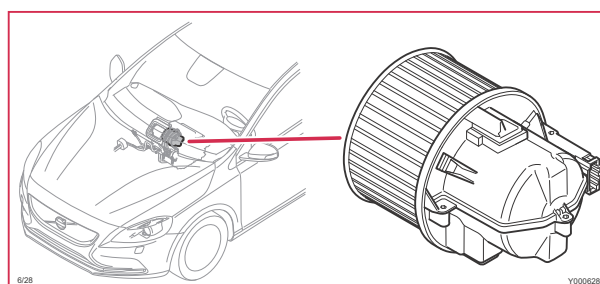

6/22 乘客座椅，向上 / 向下后缘

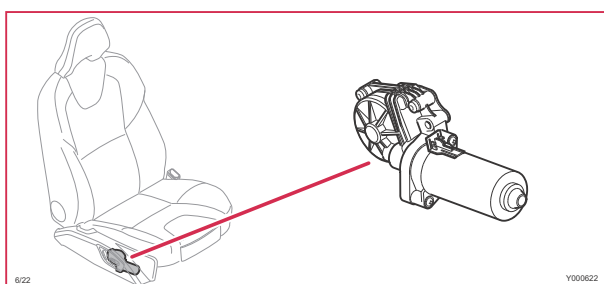

6/32 后车窗雨刷马达

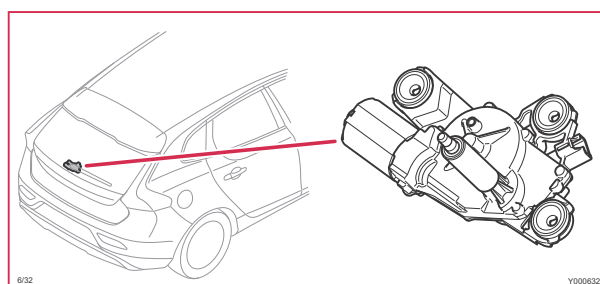

6/23 乘客座椅马达，靠背角度

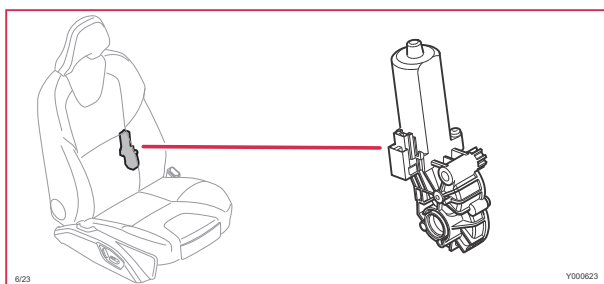

6/33 燃油泵

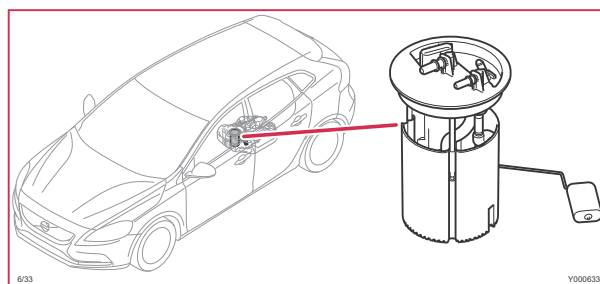

6/25 起动机

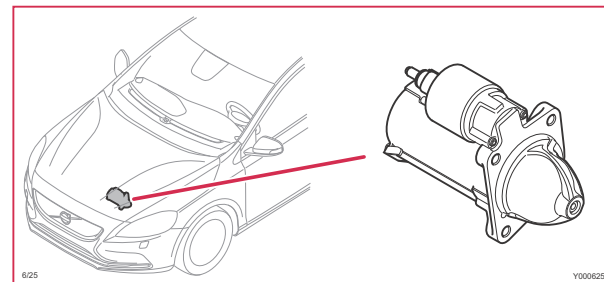

6/35 燃油泵辅助加热器

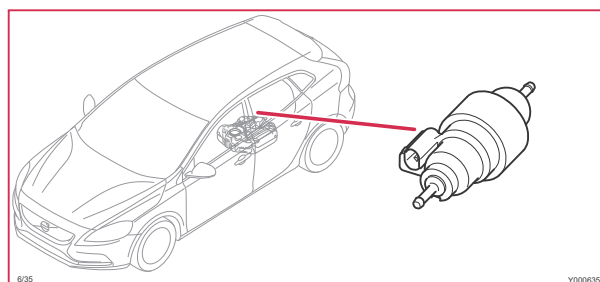

6/36 锁止马达，中央锁，左前车门

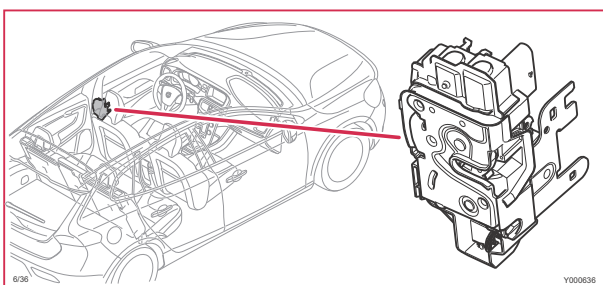

6/55 锁止马达，中央锁，右前车门

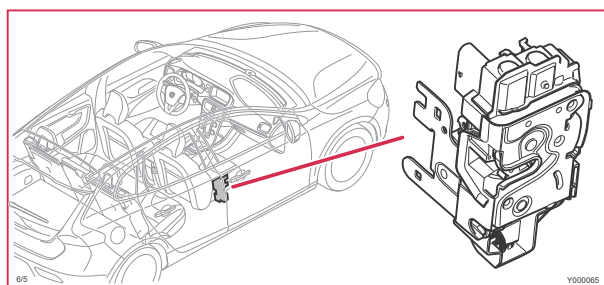

6/37 锁止马达，燃油加注盖

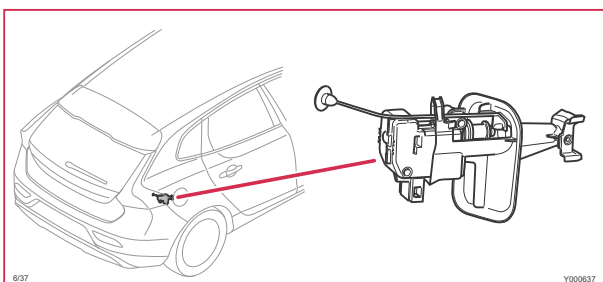

6/56 锁止马达，中央锁，右后车门

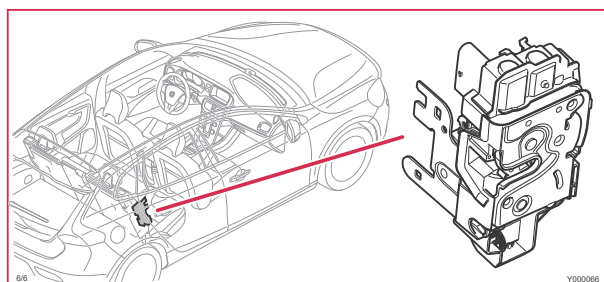

6/38 左头灯调节马达

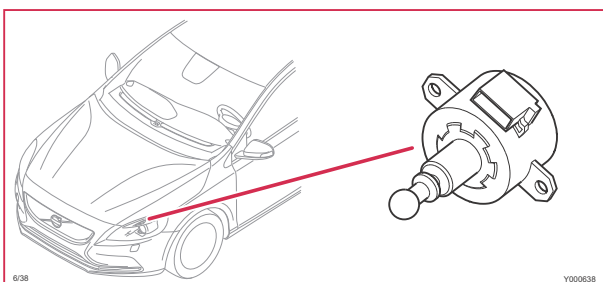

6/57 锁止马达，中央锁，右前车门

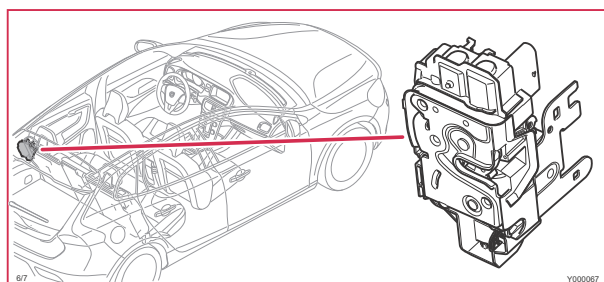

6/39 右头灯调节马达

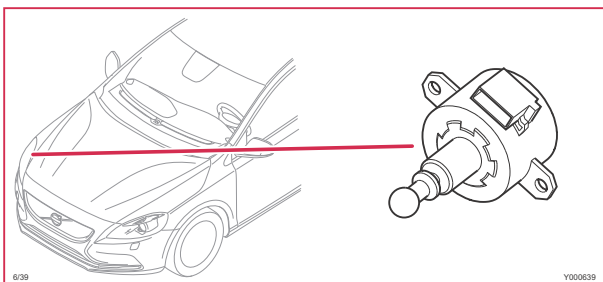

6/58 驾驶员车门前电动窗马达

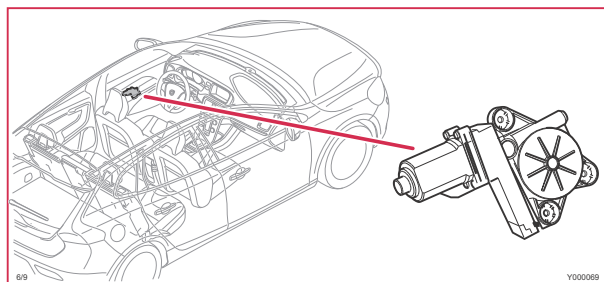

6/48 调节风门马达模块（DMM），再循环

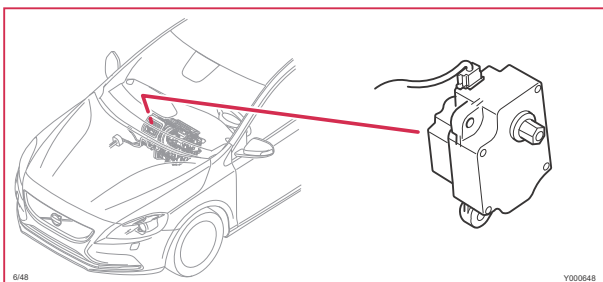

6/59 左后电动窗马达

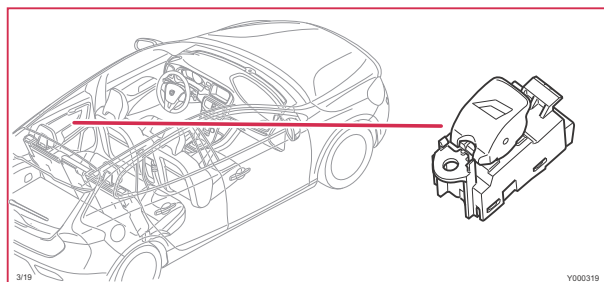

6/60 左前电动窗马达

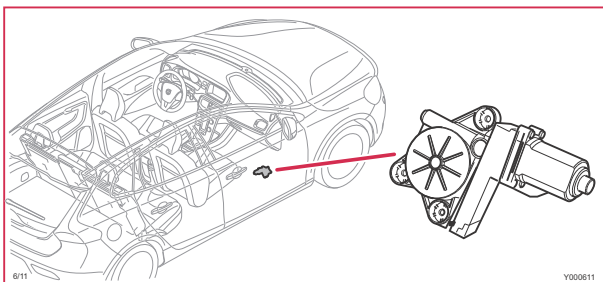

6/69 调节风门马达模块 (DMM)，通风 / 地板 / 除霜

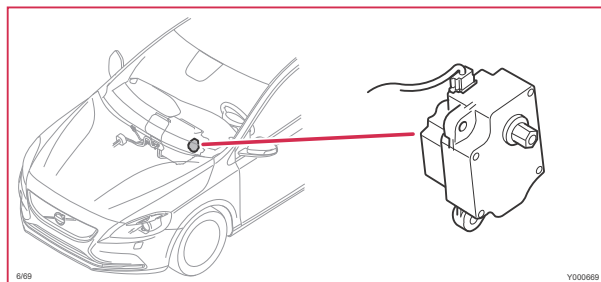

6/61 右后电动窗马达

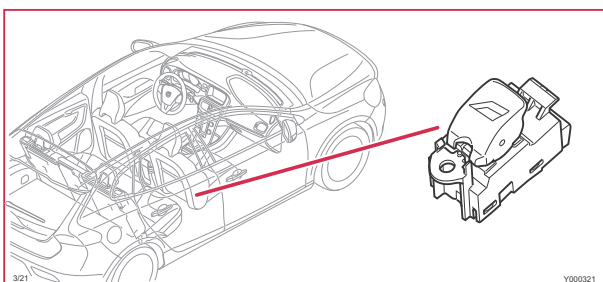

6/73 冷却液泵

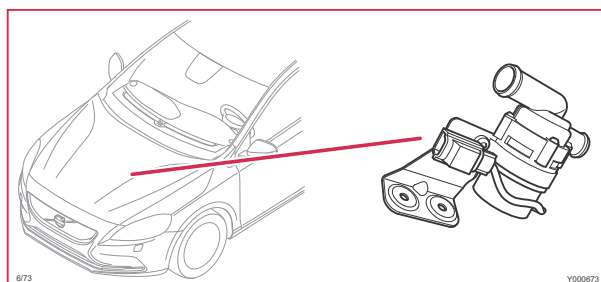

6/62 左侧电控后视镜

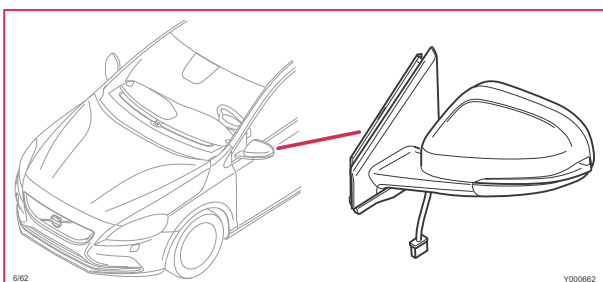

6/95 调节风门马达模块 (DMM)，温度，左侧

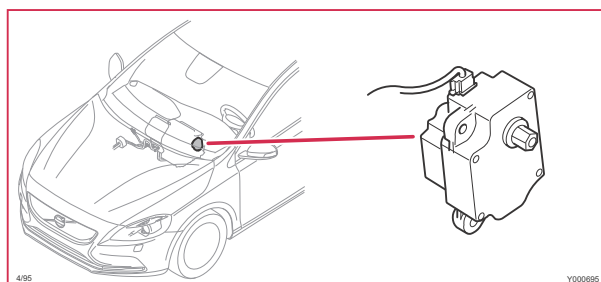

6/63 右侧电控后视镜

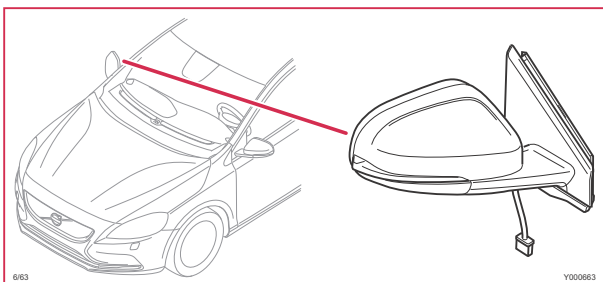

6/96 调节风门马达模块 (DMM)，温度，右侧

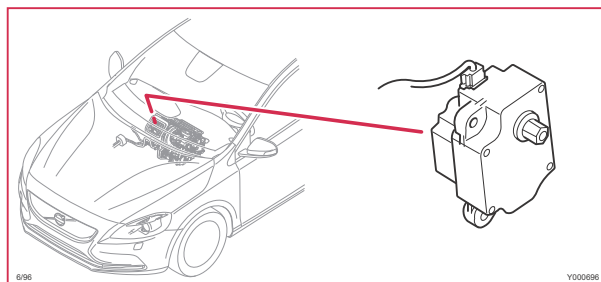

6/68 锁止马达，中央锁，左前车门

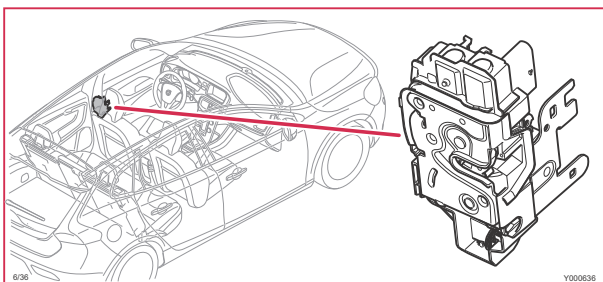

6/102 调节风门马达模块 (DMM)，除霜器

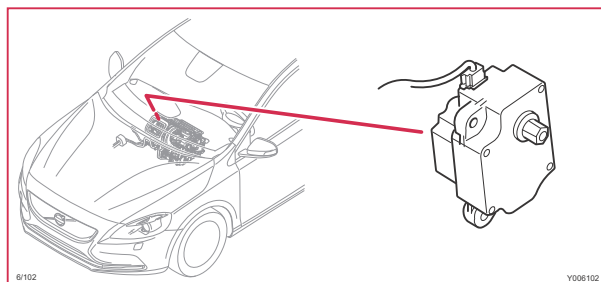

6/103 调节风门马达模块 (DMM)，地板 / 通风

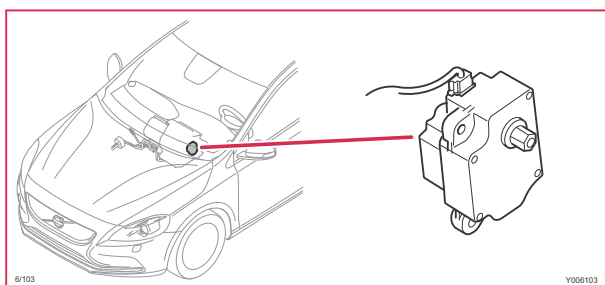

6/163 电子动力转向模块 (EPAS)

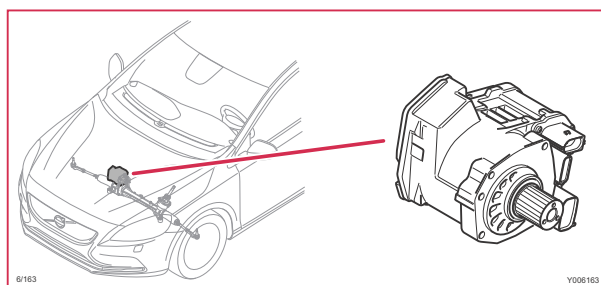

6/104 高压头灯喷洗器马达

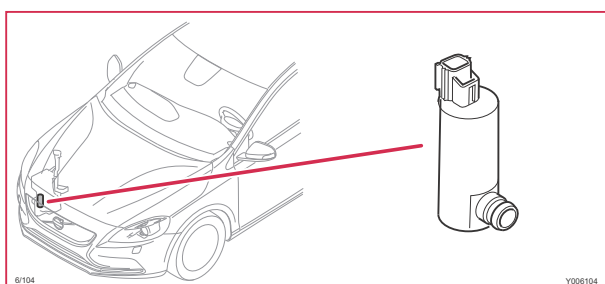

6/164 电子动力转向模块 (EHPAS)

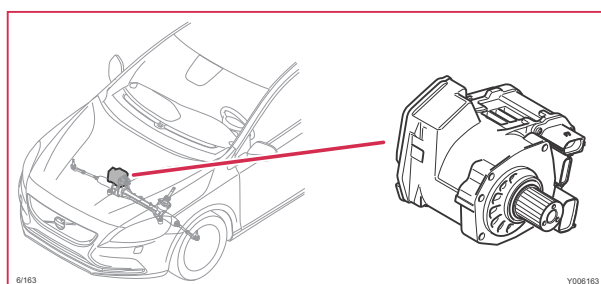

6/120 节气门单元

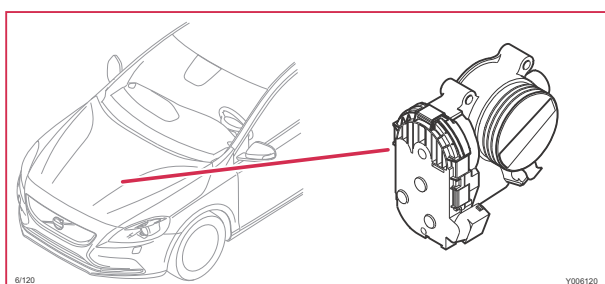

6/179 电子 机油泵

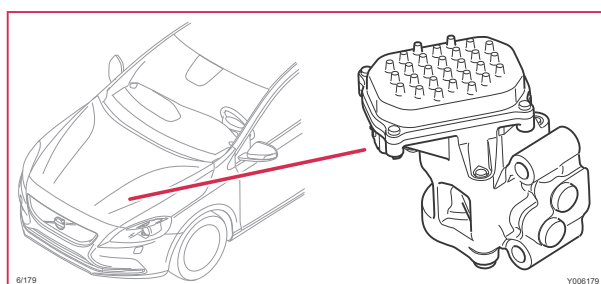

6/127 清洗器马达

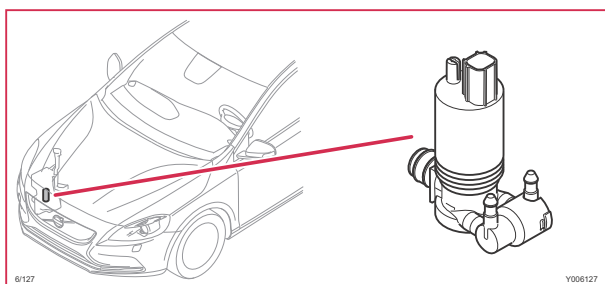

7/4 制动液液位传感器

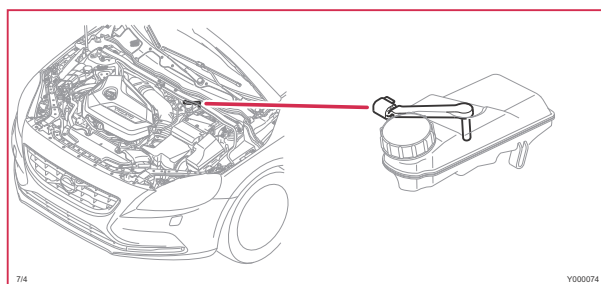

6/143 调节器马达，涡轮增压发动机

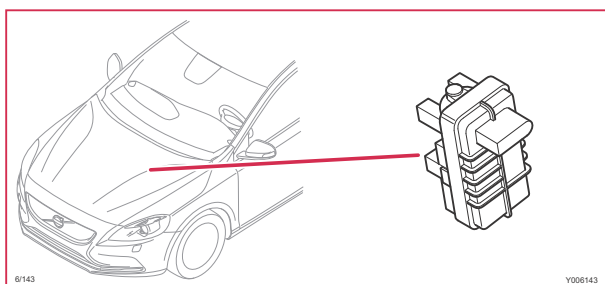

7/5 喷洗器液位传感器

